

TCAT All In One Navigator
User's Manual
for NISSAN NAVARA
QZ- 8110NT

Without written consent, any part of this user manual should not be used or re-published in any way. All the products and companies mentioned in the user's manual belong to their own proprietor. Specifications are subject to change without further notice! The user manual is for reference only; please refer to the product for actual operations.

COPY RIGHTS © 2014 ALL RIGHTS RESERVED.





TCAT All In One Navigator

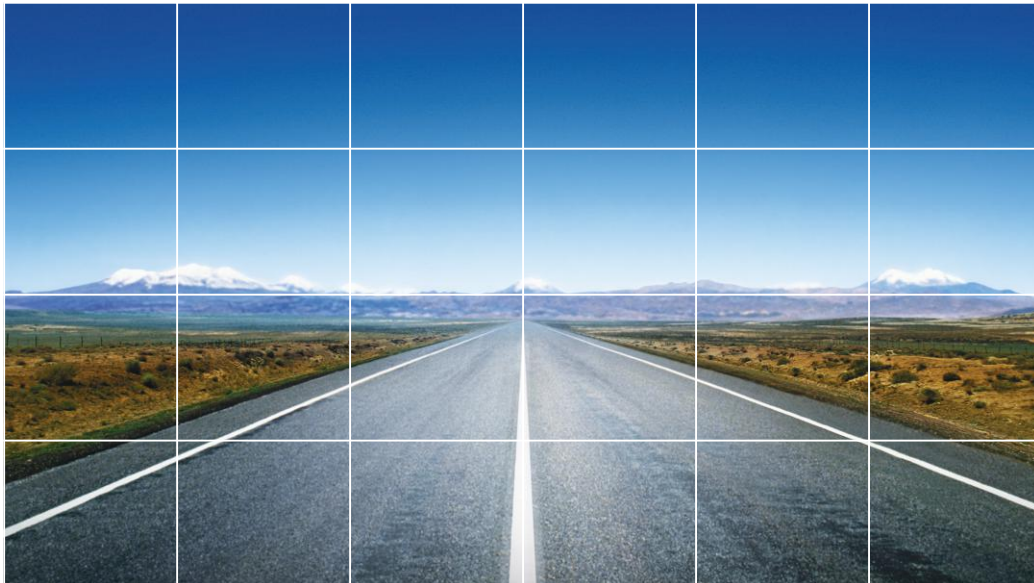

Safety Precautions	1
Product Introduction	2-3
Features	
Basic operation	
Functions and Applications	4
Functions and appearance customization	
Main menu	5
Navigator	5
Satellite signal reception	6
Music	7-8
Radio	9-11
DVD	12-13
Apps	14
iPod	14-15
Bluetooth	16-18
Movie	19-20
E-link	21-24
Voice control	25-27
Files	28-29
Audio settings	30-31
Options Settings /Other functions	
Language/Date/time	32
Display	33
System/Reverse camera	34
Remote control	35-38
NAVARA technical spec	39
Troubleshooting guide	40-42
Care and maintenance	43



Note:

Please read this manual and any other info included, prior to using this product. It is important to be aware of the warnings for the safety of all users and the device.

- **DO NOT** setup or make any setup changes while driving vehicle. Make sure vehicle is stopped and parked safely before entering any set up info or changes.
- It is illegal and unsafe to play any video that may be viewable by the driver in most regions. Please obey all rules and regulations.
- Navigation is for reference only. Routes, reception, and road conditions may change without notice.
- Do not attempt to install or repair the device. Installation and repair of device is dangerous and should not be attempted by anyone other than an authorized service centre.
- Do not touch the screen with sharp objects. Do not press against the screen with hard objects. Doing so will damage the screen display or touch screen.
- To ensure the device works normally and to prevent damage, do not expose the device to extremely damp air or liquids of any kind.
- The device only supports the standard 12cm DVD/CD sized discs. Do not insert discs of other size or any other objects into the device. This device only supports one disc at a time. Do not attempt to load more than one disc at any given time.



Important hints and warnings:

Information with this symbol is important. Please pay special attention to notes with this symbol.



Product Introduction

This multimedia entertainment system integrates GPS navigation, audio and video entertainment, and mobile applications like Bluetooth and E-Link.

Features



- Digital TFT LCD screen, 800*480 Resolution, Touch Control.
- Navigation Map display with Route Plan, Advanced POI Management.
- Bluetooth hands-free, phonebook transfer, A2DP function.
- Music/Movie
- DVD player, compatible with DVD, DVD-R/RW, DVD+R/RW, VCD, CD, CD-R/RW, MP3.
- Radio AM/FM/RDS.
- iPod connectivity.
- Date and Time
- E-link function



To turn the unit on, press the power button while the vehicle is in the ACC on position. To turn the unit off, press the power button or turn the vehicle off.



Note:

Remove protective film from the touch screen before operation.



Calibration

Calibrating the touch screen will line up your physical touch to where the device perceives your touch is. If your touch doesn't line up to where it should on the screen, you may need to re-calibrate the touch screen.

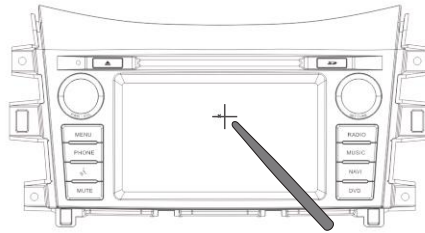

Touch the "Options" icon in the main menu, Next touch the "System" tab. Touch "Calibration" to begin.

Touch the "+" in the center of the screen. The "+" it will move to a new location each time you touch it until calibration is complete (center, top left, top right, bottom left, and bottom right). The calibration screen will close automatically, or a prompt will ask you to touch anywhere on the screen to accept changes.

Switching Programs



You can switch programs by pressing the "source" button on Steering Wheel Controls, pressing an application button on the unit, minimizing the program and selecting another application, or pressing the "Menu" button on the unit and selecting another application.



Note:

- Radio, Movie, Music, DVD & E-Link cannot run simultaneously. Only one of these applications can run at one time. However, Radio, Music, DVD & Bluetooth Music can run together with Navigation in the background.



- If the Navigation and Bluetooth applications are running at the same time, the Bluetooth will have priority during a phone call, and audio from the navigation will be muted for the call duration.



Functions and Appearance customization



Note:

The images used in this manual are meant for a guide only, and may not be shown exactly as displayed on your unit.

- To switch application or position of applications displayed, press and hold any of the icons in the main menu or "Apps" menu until dotted lines appear.
- Touch any icon to display that icon's edit menu. Touch "Delete" to create a blank space, "Edit" to choose another application from the application menu, or "Default" to restore original icon settings.
- Touch and drag any icon to desired position. Touch anywhere outside of the dotted area to resume regular icon function.

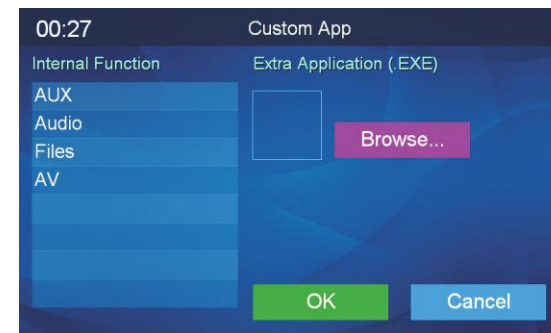
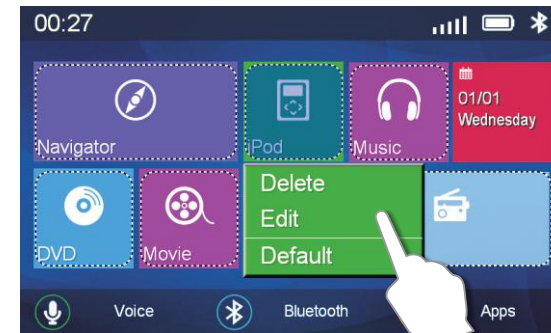



This is the default screen shown when you turn the unit on. Touch "Navigator" for GPS navigation, "Music" for MP3 playback, "DVD" for DVD and CD playback, and "Apps" to open the apps menu. This screen will also show current media info, as well as the date and time. You can come back to this menu at any point in time by minimizing or closing the current program, or pressing the "Menu" button on the unit.



 **Navigator**

Touch "Navigator" in the Main Menu or press the unit's "NAVI" button to enter the navigation interface.

 **Notice:**

The "NavIQ" folder in SD card contains the navigation program files. Do not delete any of these files; When the navigation function is operating, it is not allowed to plug out the SD card, or it will stop the navigator from functioning properly.



Satellite signal reception

The system receives satellite signals automatically, however the surrounding environment and weather conditions may result in lower signal reception. Lower signal reception may cause delayed location tracking, and sometimes can cause periods of signal loss.

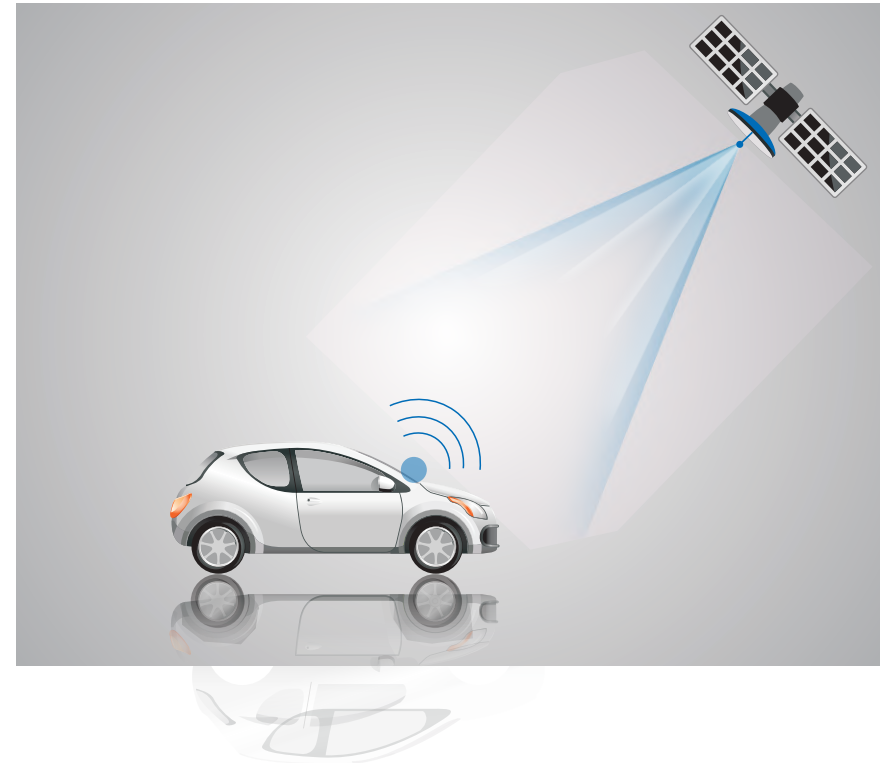

Touch "Music" in the main menu to start the music player. You can also double tap audio files in "Files" app to automatically open the music player and play files.
 Music file supported: MP3 / WMA / WAV.

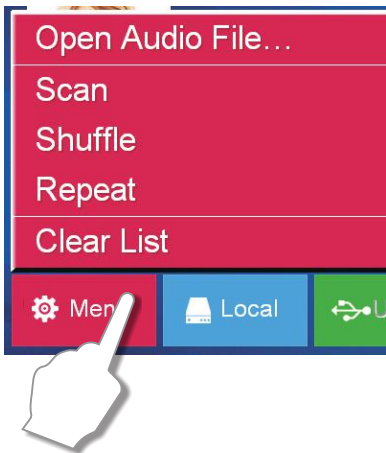
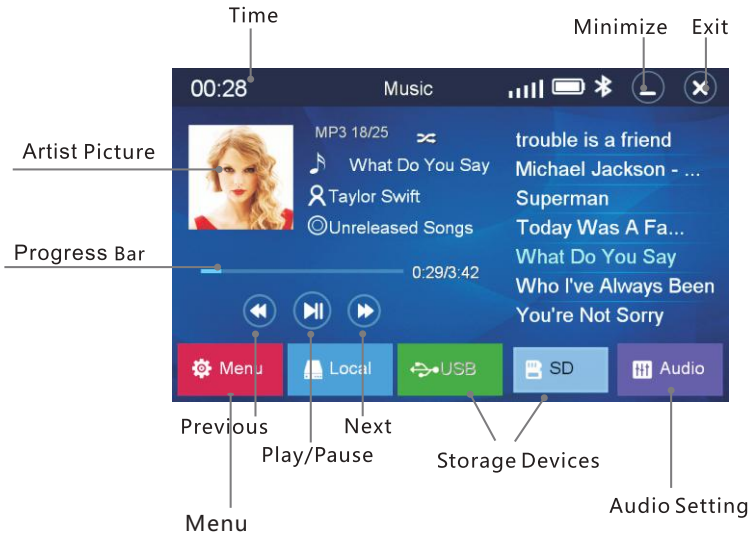

Touch the "Menu" icon to show "audio player settings" menu.

Touch "Open Audio File" to select files to add to your playlist. Touch "Scan" to scan songs in the playlist. Select playback mode by touching "Shuffle" or "Repeat".

Touch "Clear list" to delete the existing playlist (this will not delete the audio files)



Audio Player

Touch Open audio file to view the audio files in the local device, USB and SD card.
 Click one file or "All" and click "OK" to play

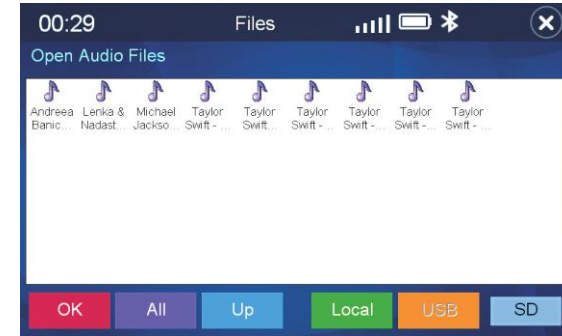

- The system has built-in MP3 player, it supports MP3, WMA and WAV format.
- The information screen displays the title, artist, and progress status for the music file currently playing.
- The progress status position can be dragged to change the point at which the music file is playing at any time.

Load folder: Touch 'open audio file', select songs folder, click 'OK', then automatically loading audio files

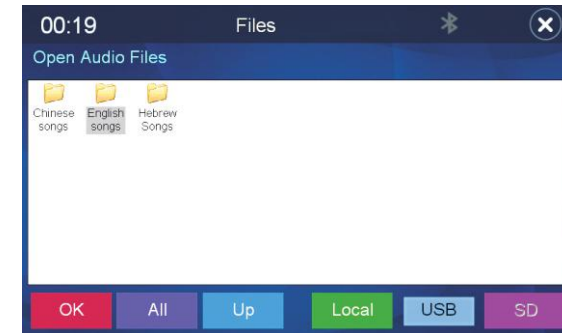

Add NOTE: To autoload all songs, simply click on the music source, Local, USB, SD.



Touch the "Radio" icon in the main menu, or press the unit's "RADIO" button to enter the Radio application. You can search for radio stations, adjust radio frequencies, save favorite stations to presets.



Fine adjustment on screen

You can adjust the current frequency in a small range through fine adjustment. Every time short press the fine adjustment button, the frequency will change: FM increases by 0.1 MHz a step, AM increases by 9KHZ a step, and the radio station can be saved. You can also fine tune the frequency by using the right side rotary knob.

Seek

Users can press this button to start searching the previous/next available station. Radio will stop at previous/next strongest station frequency.

Scan

Short press this button to search a radio station while the radio is playing, and long press the blank block to save the radio station. Long press this button to auto search radio station and the stations will be saved automatically. The radio station searched is named in a default way: "frequency".



When you touch the radio "option" button, you can choose "Delete Station", "Delete All Stations", and "Audio".



Delete Station / Delete All Stations

To remove a saved preset station, select the station you wish to delete from the preset menu, press the "Option" button, then press "Delete Station". To remove all saved presets, press the "Option" button, then press "Delete All Stations".

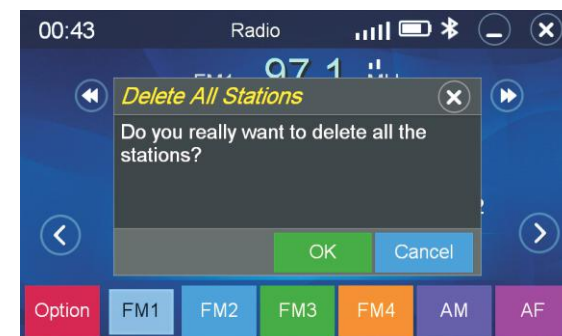

**Notice:****RDS(Radio Data System)**

This product supports RDS, and provides display and control information for 87.5~108 FM.

AF(Alternative Frequencies)

The AF function automatically makes minor changes to the frequency ensuring the strongest possible radio signal.

To use the AF function, wait until the RDS information is received from a radio station, then press the AF button.

**DVD**

Touch the "DVD" icon in the main menu, or press the unit's "DVD" button to enter the DVD application. Touch anywhere on the screen to display the DVD playback menu.

- Changes made to the audio or subtitle options using the DVD playback menu only apply to the current playback settings. To change audio or subtitle settings for every playback, touch the "SET" button in the DVD playback menu and adjust the language options in the DVD player system settings. If the language settings chosen are not available with that DVD, the default DVD language settings will be used.
- Keep discs clean to avoid dust/pollutants, or disc may not operate properly, and possibly cause damage to unit
- Please do not operate "Eject" in 5 seconds after inserting the disc. It needs 3 seconds to recognize "Eject" command.

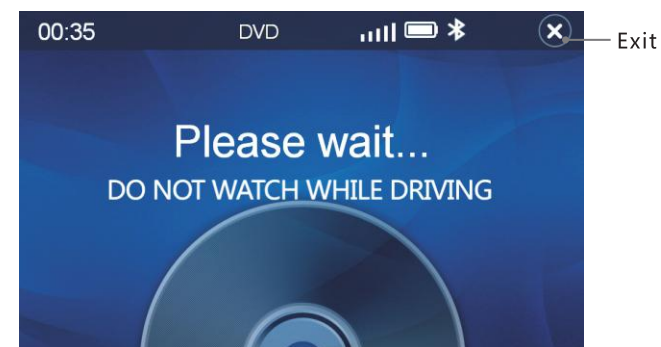
**DVD/CD Playback Menu**

- ⏸ Touch to play or pause DVD playback.
- ⏮ Touch "previous" button to skip to the previous chapter/track/scene.
- ⏭ Touch "next" button to skip to the next chapter/track/scene.
- ⏪ Touch "Rewind" to reverse DVD playback at 2x speed. Touch "Fast Backward" again to go back at 4x, 8x, and 16x regular playback. Touch "play" to return normal playback.
- ⏩ Touch "Fast Forward" to increase DVD playback to 2x speed. Touch again to increase speed to 4x, 8x, and 16x regular playback. Touch "play" to return normal playback.



REPEAT

Touch "REPEAT" to repeat playback while playing CD/DVD.

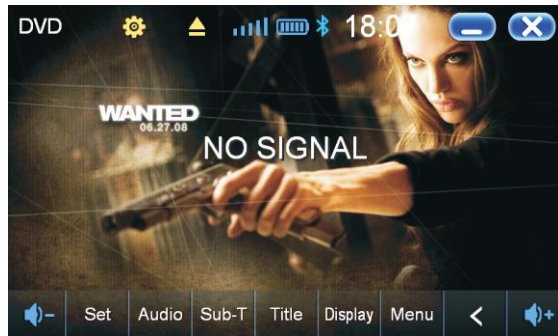

>

Touch **>** icon to see second set of DVD options.

SET

Touch "SET" to open the DVD player system settings. The DVD player settings can be set in the general settings page, audio settings page, video settings page, and other settings page. DVD menu language can also be changed in the DVD player system settings.

AUDIO

DVD: Touch "AUDIO" to display the current language audio setting. Touch "AUDIO" again to cycle through DVD language audio options (Different DVDs have different audio options)
 CD: Touch "AUDIO" to display current playback setting. Touch "AUDIO" again to cycle through playback only in the right side, only in the left side, right and left side signals combined, and stereo audio playback.

SUB-T

Touch "SUB-T" to switch through the sub-title languages available. Languages available are limited to what is included on the DVD.

TITLE

Touch "TITLE" to display the title information while the DVD is playing.

DISP

Touch "DISP" to display playtime, title, remaining time, chapter time, remaining time in the chapter, etc. while DVD is playing. Touch "DISP" again to exit.

MENU

Touch "MENU" to display the DVD root menu.



APPS

Touch the "Apps" icon in main menu to open the apps menu. The apps menu contains the "Files", "AUX", "Audio", "Option" etc icons.



iPod

This device supports several kinds of Apple devices (iPod, iPhone, iPod Touch, etc.), giving you music playback and battery charging at the same time. To use your apple device, connect the device to the USB. Touch the "iPod" icon in the main menu.

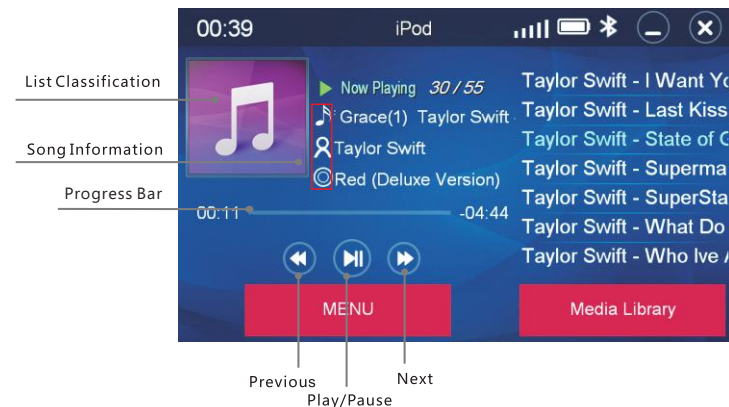

The iPod application will display the current song title, artist, and album playing, as well as allow you to choose from your apple device's playlists, Artists, Albums, and Genres. You can use the play/pause/next track/previous track options, as well as the repeat and shuffle options.

Touch the "Media Library" to get List Classification.



Touch the "MENU" button to change play mode.

MENU

>>>

- Shuffle: Off
- Shuffle: Songs
- Shuffle: Albums
- Repeat: Off
- Repeat: One song
- Repeat: All songs

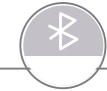

Bluetooth

Touch the "Bluetooth" icon in the main menu .



To make a Bluetooth connection, you must pair the device with your phone.

Pairing device

- Open your mobile phone's settings menu.
- Locate the Bluetooth settings.
- Turn on Bluetooth.
- Search for Bluetooth devices. Please refer to owner's manual of your phone for more details.
- Select NAVARA, and enter 1234 for password.



Notice

- If you have paired your phone with the device, the device will automatically connect your mobile phone the next time you open the Bluetooth application. (The mobile phone's Bluetooth connectivity must be turned on before connecting.)
- If your Bluetooth mobile phone has already been added to the Bluetooth devices list, you can manually connect your mobile phone in the devices menu.

Disconnecting Bluetooth devices

Touch "Devices" , and then select the mobile phone's Bluetooth name. Touch "Disconnect" to disconnect the phone.



Devices

Touch "Devices" to view unit's pairing history. Touch "Connect" to attempt a connection to a phone selected in the list. Touch "Delete" to remove the selected device's pairing history. To select a device, touch any of the device names in the list.

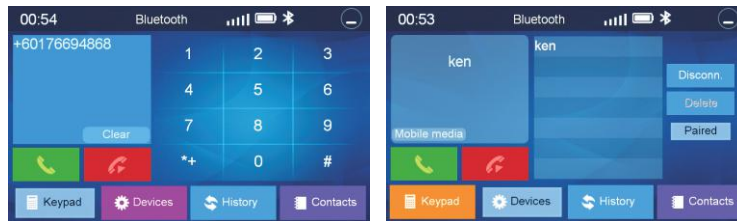

Bluetooth Music(A2DP)

Enter the mobile phone audio interface by clicking "Mobile Media" in the Bluetooth main menu. You can control the mobile phone's playback using the play/pause, previous and next buttons. (Notice: Mobile phone must have A2DP to use this feature.)

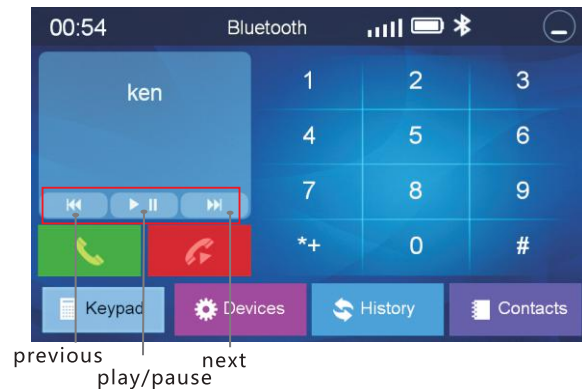

Disconnecting Bluetooth devices

Touch "Devices", and then select the mobile phone's Bluetooth name. Touch "Disconnect" to disconnect the phone.

Contact & Call History Sync

Once your phone is connected, your contacts and call history will automatically sync with the device. To update the list, touch "Contacts" then "Sync. Now".

Note: Please wait until contacts list sync completely before touching and dragging the contact list.

Dialing and answering calls

Please confirm that your mobile phone has been successfully connected with the unit before dialing and answering calls.

Connecting Status



Use the digit keyboard in Bluetooth interface to input the desired numbers then touch the call icon to connect a call. If you want to change the phone number, you can press the keypad button to delete one by one. You can also use your mobile phone to dial, however it is not recommended when vehicle is not in park. Touch the end call icon to end the call.

Switch

When you making a call by the bluetooth, you can press Switch to switch the audio between the cellphone and the navigator. In cellphone mode, it's more private while there are other occupants in the car. In navigator mode, it's more convenient and safe.

Caution : Stop / Park the vehicle when using the cellphone mode.

Contacts and History

To view the contact or history lists touch "Contacts" or "History".

Call history is split in to three categories; missed, received and dialed. Touch "Missed" to see a list of missed calls, "Received" to see a list of recent calls you've answered, and "Dialed" to see calls you've made.

To search through the list, touch and drag any section on the visible part of the list, or touch the search box and type in your contact's name.

Contacts: all your contacts in your phone will be downloaded completely in this device.

Note: Once connected, please select allow permission of download contact at your mobile phone.

TTS: If you want to hear how the person's name is pronounced using voice command, touch the name first, then press "TTS". The name will be pronounced by the system automatically. (Note: the TTS pronunciation is English & Chinese only)



Movie

Touch the “Apps” icon in the main menu, then touch the “Movie” icon in the apps menu to open the movie application. Start the player by double tapping a movie file, or by touching a file and pressing the “Play” button. You can also open the movie application by double tapping a file in the “Video” tab of the “Files” application.

Video formats supported:

Video Codec	Profile	Resolution
MPEG-4	Simple Profile	1280x720
	Advance Profile	1280x720
WMV7	Simple Profile	800x480
WMV8	Simple Profile	800x480
WMV9, VC-1	Simple Profile	720x480
	Main Profile	720x480
	Advance Profile	720x480
H.264	Base line	1280x720
	Main Profile	1280x720
	High Profile	1280x720
Real Video	Rv3	1280x720
	Rv4	1280x720
Vp6		800x480
Vp8		800x480
DivX 4,5,6	Simple Profile	1280x720
	Advance Profile	1280x720

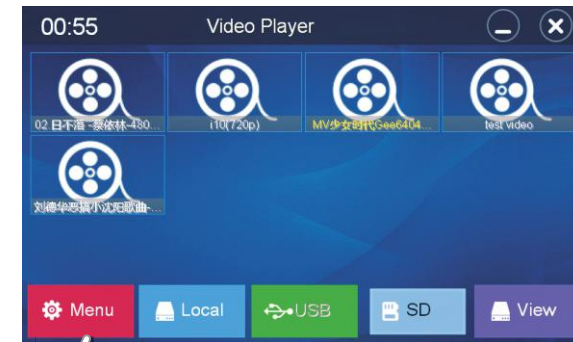
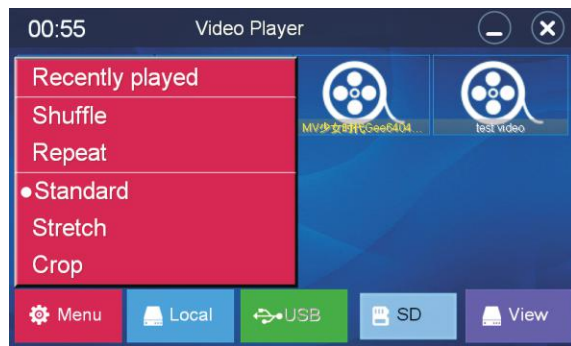

Change Video Player file preview

Touch Play/Pause, next file, or previous file to change playback settings.

Touch the to exit the movie application.

The video information displayed includes file name, format, current playback position, and total play time.

Touch and drag the process bar to fast forward or rewind to any point.

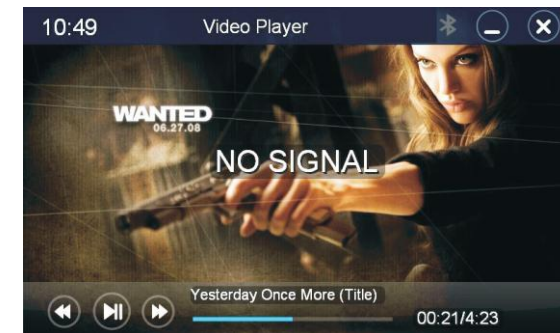

Elink enables mirroring of most Android smartphone screen to the car navigation unit screen. It allows users to view and control the commonly used functions such as Music, Movie, Phone, Navigation, Internet connectivity from the smartphone.

How to activate: Firstly, enable "Developer Options & USB Debugging" mode on the Android smartphone. Please click on the  icon on the ELINK starting page to view the step by step guide to do this. Also, please ensure Mobile Internet Data is available on the phone for first time connection.

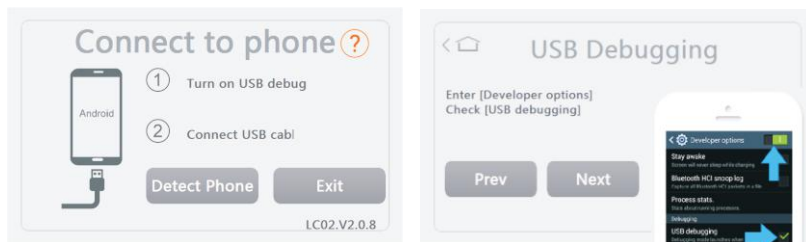

Next, connect the phone's USB cable (not supplied) between the phone and the USB port in the vehicle.

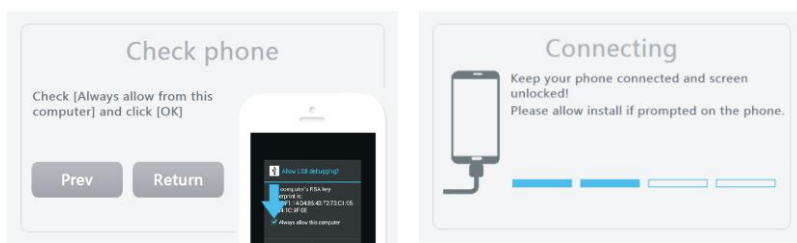



- Note:**
1. Please click " Always allow " if there is a prompt on the smartphone.
 2. Turn on the Bluetooth and pair to the Navigation unit to enjoy sounds from the car speakers.
 3. First time connection will take around 30 seconds.
 4. Please switch off unit's Navigation software before starting Elink.

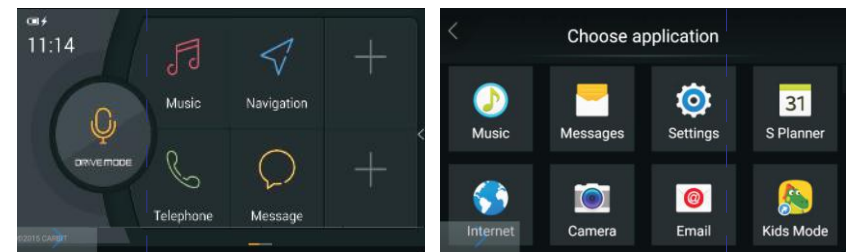

After successful connection, Drive Mode app will automatically start. This app is specifically designed for in-vehicle usage. Press the "+" icon to add new functions from the phone.

- Note:**
1. Long press to delete/change the apps.
 2. Swipe horizontally to swap pages. Total of 3 pages is available.
 3. Use your fingernail instead of the flat area of the finger for improved response and accuracy.



Tap the transparent Blue icon  at the bottom left is to expand the following functions from the smartphone.

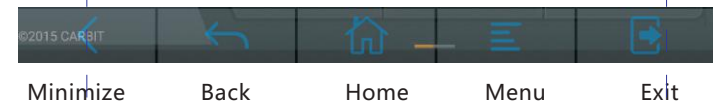

Hint: You can drag and move this icon to top or bottom position when it is minimized.

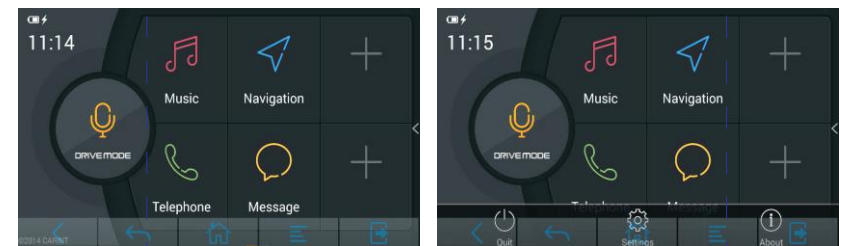

Exit the Drive Mode app to view your phone screen. You can control the phone via the navigation touch screen.

- Note:**
1. Users may experience lag due to limited connection speed via USB cable.
 2. Turn on "Screen Auto Rotation" to toggle between portrait or landscape orientation.
 3. Touch sensitivity may be increased by using the finger nail instead of the flat area of the finger.

E-LINK compatibility list

No.	Brand	Type	OS Ver.	No.	Brand	Type	OS Ver.
1	Samsung	SM-G900F	Android4.4.2	30	Lenovo	A516	Android4.2.2
2		GT-I9505 GT-I9500	Android4.3/5.0	31		S960	Android4.4.2
3		GT-I9300	Android4.3	32		S920	Android4.4.2
4		SM-N910C	Android4.4.3	33		S850	Android4.2.2
5		SM-N9005	Android4.4.2/5.0	34		S930	Android4.4.2
6		GT-N7102 GT-N7100	Android4.4.2	35		A335e	Android4.3
7		SM-A500FD	Android4.4.4	36		A916	Android4.4.4
8		SM-A300FD	Android4.4.4	37		K50 -t5	Android5.0
9		SM-G530H	Android4.4.4	38	A690e	Android4.4.4	
10		SM-G716 SM-G715	Android4.4.4	39	OPPO	N5117	Android4.3
11		GT-I8852	Android4.1.2	40		R6007	Android4.2.2
12		SM-G3509	Android4.1.1	41		X9007 X9006	Android4.3
13		SM-G357FZ	Android4.4.4	42		X909	Android4.3
14		I9205	Android4.4.2	43		R7005	Android4.4.2
15		SM-G8508S	Android4.4.4	44		R850	Android4.3
16		GT-I9300I	Android4.3	45		R8006	Android4.4.2
17		SM-G3818 G3819D	Android4.2.2	46		Xiao MI	MI-ONE C1
18		SM-T321	Android4.4.2	47	MI-ONE		Android4.1.2
19		GT-I1850	Android2.3.6	48	MI 2		Android4.1.1
20	HTC	M85w	Android5.0	49	MI 2S		Android4.1.1
21		D516D	Android4.3	50	MI 3		Android4.2.2
22	Sony	c6603	Android4.4.4	51	MI NOTE 1 LTE		Android4.4.4
23		c5305	Android4.3	52	MI 3W		Android4.4.4
24		D2005	Android4.4.2	53	MI 3C		Android4.4.4
25		LT22i	Android4.1.1	54	MI 4W		Android4.4.4
26	LG	Nexus5	Android5.0	55	HM 1SW		Android4.3
27		Nexus 4	Android5.0/5.1	56	HM NOTE 1LTE		Android4.4.4
28	Motorola	Moto G(2ver) 4G	Android5.0.2	57	Hua Wei	Ho1-T00	Android4.4.2
29		Milestone	Android2.3.7	59		G620S-UL00	Android4.2.2

E-LINK compatibility list

No.	Brand	Type	OS Ver.
59	Hua Wei	G7-UL20	Android4.4.4
60		G6205-UL00	Android4.4.4
61		MT7-TL10	Android4.4.2
62		G620-L72	Android4.3
63		PE-TL00M	Android4.4.2
64		CHE2-UL00	Android4.4.2
65		G750- T00 G750- T01	Android4.2.2
66	Y618-T00	Android4.2.2	
67	X1 7.0	Android4.4.2	
68	VIVO	Y27	Android4.4.4
69		Y622	Android4.2.2
70		X5MAXL	Android4.4.4
71		Y28L	Android4.4.4
72		Y23L	Android4.4.4
73		X5	Android4.4.4
74		Xplay	Android4.2.2
75		X520L	Android4.3
76		X710L	Android4.1.2
77		Y17W	Android4.2.2
78		Y29L	Android4.4.4
79		Y13L	Android4.2.4
80		Y22iL	Android4.4.2
81		Y927	Android4.4.4

 **Warning**

- (1) The phone list shown is for reference only
- (2) Some phones may not supported due to manufacturer, operating systems, carrier or etc are different from phone list.
- (3) The phone list will be updated periodically. Kindly contact NAVARA for the latest list of compatible phones





Voice control

Voice Control is a feature that allows users to control the product by speaking different commands. By removing the need to use buttons, dials and switches, users can easily operate functions and services with their hands full or while driving.



“Press and Speak”

Press  on Steering Wheel Control to activate the Voice Control function. When you hear a beep and Voice Control UI appears on the screen, speak your command.

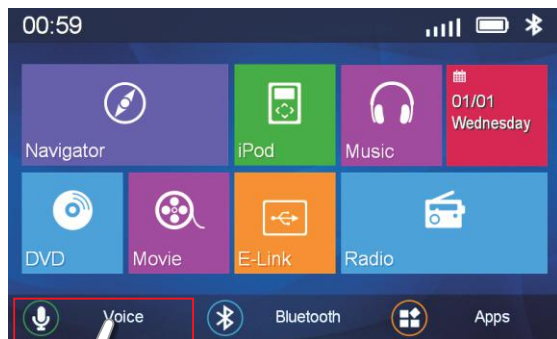

Alternatively, you can press the Voice button on the main menu.



Available Commands

For different function mode, some voice commands are different.

WinCE Voice Control commands							
Commands		Commands		Commands		Commands	
Basic Function	Navigator	In Music Mode	Next	In DVD Mode	Next	In Bluetooth Mode	Call 'name'
	Music		Previous		Previous		Answer
	iPod		Volume Up		Volume Up		Reject
	Radio		Volume Down		Volume Down		Yes
	Bluetooth/Telephone		Close		Close		No
	DVD/Disc		Shuffle		Repeat		Sure
Movie	Repeat	Minimise	Cancel				
		Storage Card/SD Card				Phone Media	
		Local				Previous	
		USB				Next	
		Music Name				Close	
						Minimise	
Commands		Commands		Commands			
In Radio Mode	Previous	In iPod Mode	Previous	Others	Off LCD		
	Next		Next		Help		
	Volume Up		Volume Up				
	Volume Down		Volume Down				
	Close		Shuffle				
	Frequency (FM+Freq.)		Repeat				
	Scan		Close				
Minimise	Minimise						



Notice

Orange marked place means available in second Level mode (Phone Media Mode).



You can use the "Help" command to show the list of voice commands. Click on each command to hear the preset voice commands.



So for example, you can say:

- Navigator/Music/DVD
- FM 80.7 (Frequency station should already be saved in the radio.)
- Rolling in the deep (Song Title in the playlist)
- Call 'name' (Contact in the downloaded phonebook)



Notice

- If you are having difficulties getting the device to recognize commands, please try to speak more slowly and clearly.
- For best results when you're using Voice Control, please keep the surroundings quiet. Any surround noise may influence the recognition
- Be ready to speak when the beep has completed, long pauses may cause unexpected results.
- Some short names may be too similar and may be too hard to distinguish themselves. For best results with these kinds of names, try saying both first name and last name.



Files

Touch "Files" icon in the apps menu to open the file browser.

Storage Locations:

Touch "All" to select all files available that are compatible with this unit. Touch "Local" to see files stored on internal storage. Touch "USB" to see files stored on a connected USB device. Touch "SD" to see files on the SD card.

File Categories:

Touch "Audio", "Movie", "Photo", or "Other" to see files compatible with this unit sorted according to media type.

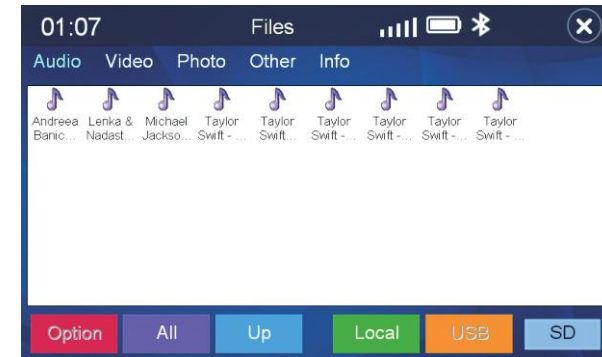

Photo

Double tap to view image files. The image viewer supports bmp, .jpeg, .gif, and .png file formats.

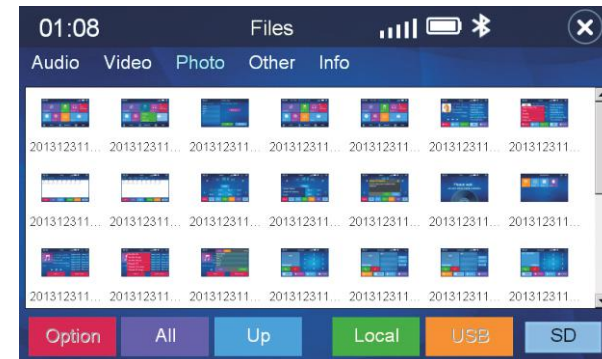



Info:

Users can check the storage information in local, USB or SD card by clicking "Info" .

- a) Total storage memory capacity of NAND Flash.
- b) Memory capacity occupied by current file and the remaining memory capacity.
- c) Respective memory capacity of music, movie, image, and other files.
- d) Respective percentage in total memory capacity occupied by music, movie, image, and other files.

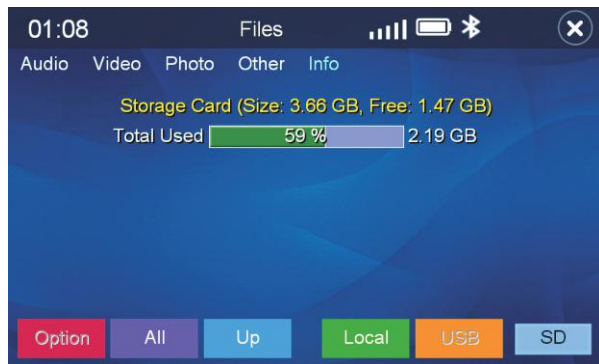

Audio

Touch "Audio" icon in Apps interface to enter the audio options menu.

To adjust treble, middle, and bass, touch and drag the appropriate dot to the desired level.

To adjust balance or fade touch the fine adjustment arrows, or anywhere in the balance/fade display.

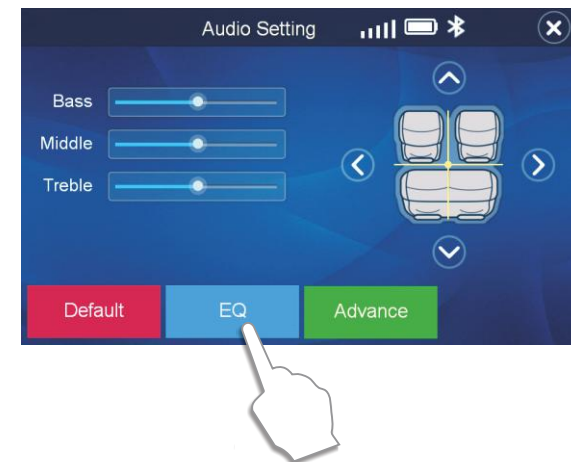

Touch the "EQ" in the audio settings menu to display the 9 band EQ and preset EQ settings. Touch from any of the 5 preset EQ settings to select them, or touch any of the dots to manually adjust a custom EQ setting. Touch the "Default" button to return to default EQ settings.

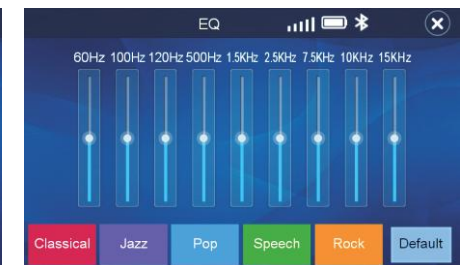
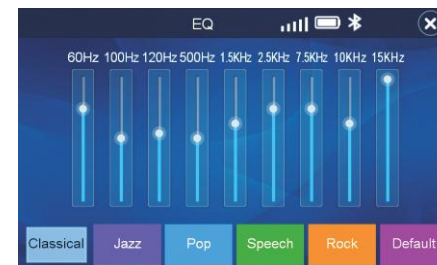

Touch the "Advance" button in the audio settings menu to open up the advanced settings.

Adjust volume levels of each program (on the left side of the screen) by touching the volume adjustment arrows. Touch the "Default" button on the left side to reset to factory defaults.

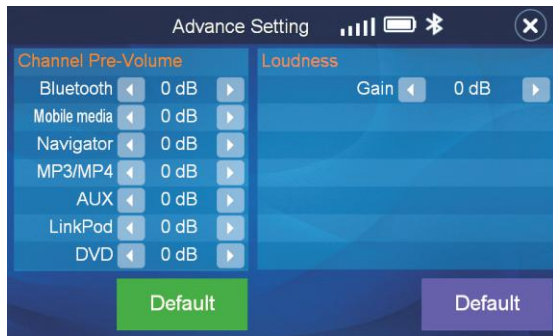

Loudness:

When "Loudness" is 1, the EQ will raise the high and low frequencies to mimic the change in frequencies when sounds are loud. Choose the frequency range affected when you increase the bass using "Bass Freq." option. Choose the frequency range affected when you increase the treble using "Treble Freq." option. Choose the preamp gain by changing the "Gain" option.



Options

Touch "Option" in the main menu interface to enter in options interface, where you can set time/date, backlight adjustment, select interface language, and adjust touch calibration.

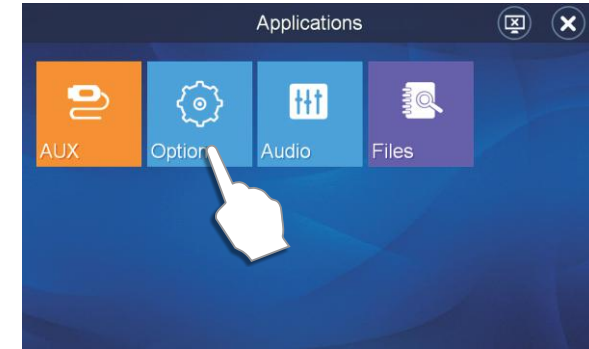

Language:

Touch the box beside "Language" to select languages, then touch the you would like the user Interface (UI) to display. Then press "apply".



Date/Time:

Touch the "Date/Time" tab to adjust time zone, date and time, and switch between 12 and 24 hours clock. Once you have made your adjustments, touch the "Apply" button to confirm your settings. (Note: When a connection is established with the GPS network, date and time will automatically be set by the software.)

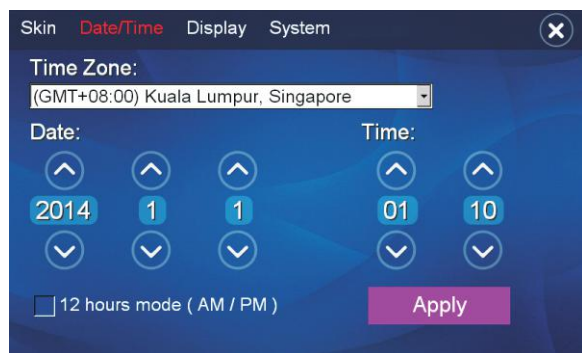
**Display:**

Touch the "Display" tab to show backlight brightness, and CCD Camera option. Touch and drag the circle to adjust the backlight brightness. Touch the box beside "CCD Camera" to enable the automatic switch to CCD display while the vehicle is in reverse.

Pause media whilst reverse

Touch the box beside "Pause Media Whilst Reverse" to enable or disable the media play while the vehicle is in reverse.

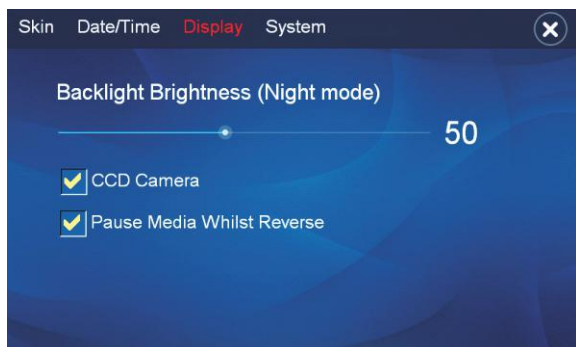
**System:**

Touch the "System" tab to view system information, update the system, and calibrate the touch screen (see page 3 for detailed instructions).

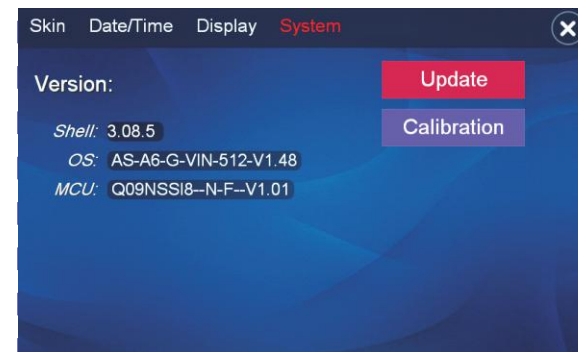

For device updates, drive your vehicle to an authorized service centre.

Reverse camera :

Engaging your car in reverse will automatically switch the unit's display to the reverse camera display. Once you switch out of reverse, the unit will resume displaying what it was showing earlier.













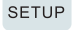

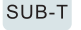

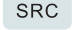
Functions of each button

Button icons	Key Functions
	Press this button to put unit in standby mode.Press it again to turn the unit on.
	Press to open the navigation interface.
	Press to enter the bluetooth function
	Press to mute the audio.
	Press to eject/insert the disc.
	Press to display the image from the reverse camera press it again to return to the screen you were previously on.
	Press to activate the voice control function.
	Press to increase the volume of the device.
	Press to enter the music interface.
	Press to enter the DVD interface .
	Press to enter EQ setting interface,you can follow your own preferences ,touch any of the dots to adjust a custom EQ setting.touch the "Default" button to return to default EQ settings
	Press to decrease the volume of the device.
	Press to return to the main interface.
	Press to return to the previous screen or exit from the DVD settings interface.



Button icons	Key Functions
	Press to move up, down, left or right in DVD setup function
	Press to select in DVD setup function
	Press to select left audio channel, right audio channel, mono, or stereo audio outputs. some discs do not support this function.
	Press to enter DVD setting interface, press it again to return to the screen you were previously on .
	Press to display the title.
	Press to switch the subtitles.
	Press to cycle between "repeat off", "repeat chapter" and "repeat disc".
	Press this button to display title, audio language, subtitle language, angle, chapter, etc.
	Press to cycle through Radio, Music, ipod, and DVD applications.
	Press to pause or play the CD/DVD.
	Press this buttons to skip backward in playback.

Button icons	Key Functions
	Press this buttons to skip ahead in playback.
	Short press "SCAN" to search a radio station while the radio is playing, Long press this button to auto search radio station and the stations will be saved automatically.
	Press the "BAND" to switch it, among FM1, FM2, FM3, FM4, AM
	Short press to select radio station; Long press to save your favorite radio station in the list



Specification

Item		Description
Monitor	size	7' inch
	Resolution	800x480 Digital LCD
DVD	Disc type	DVD-ROM/DVD+RW/DVD+R/DVD-RW/DVD-R/CD-ROM/CD-RW/CD-R/
		DVD+/-R Dual Layer Disc Support/DVD-R/RW Multi Border Support
	Frequency response	± 3 dB at 20HZ--20KHZ
	S/N	80 dB
FM	Turn range	87.5MHZ ~ 108MHZ
	Usable sensitivity	13db
	Stereo S/N	50
	Frequency response	Low 100HZ ±3dB
High 10KHZ -6dB~2dB		
AM	Turn range	531kHz~1620KHZ
	Usable sensitivity	25 dB
	Stereo S/N	50 dB
IN/OUT port	Input port	Audio,Video
	IPOD	A type,USB direct
	USB	A type, FAT 32
	Rear View (RCA)	Camera IN
	Output port	Audio,Video
AMP.	Power	45W X 4CH
	Speaker inpedance	2Ω ~ 4Ω or 100Ω ~ 200Ω(line drive mode)
Navigation	OS	Wince 6.0
	CPU speed	800MHZ
	ROM	8Gb SLC NAND FLASH
	RAM	512 Mb
	GPS	GPS_TriG
Bluetooth	V2.1+EDR	
	BC57E687C	
Power Voltage	9V ~ 16V	
Weight	3kg	
Size	337.26mm(W)*144.1mm(H)*181.98mm(D)	



Warning:

If you encounter the following situations while using the device, this troubleshooting guide is meant to help you solve the problem quickly. If the problems are still not resolved after following this guide, please consult an authorized service centre. Do not disassemble or remove the device! This may void your warranty, and/or lead to personal damage to device.

Problems	Reasons	Countermeasures
Won't power on	Vehicle may not be turned on/ key in ACC "on" position	Turn on vehicle or turn key to ACC position
	The fuse may be blown	Check fuse and replace if blown
Touch screen inaccuracy	Re-calibrate the touch screen according to touch screen calibration steps through "Options" - "System".	
Touch screen does not work	System program may be processing	Wait a few moments. Power off/on if it still doesn't function
Disc won't play	Disc not inserted correctly	make sure disc is inserted label side "up"
	Disc may be damaged	Change another disc
	Disc may not be compatible	Check disc type and region code



Problem	Reasons	Countermeasures
The screen is black with no images or monochrome when playing DVD.	Brightness, contrast or color saturation is adjusted too low.	Readjust the brightness, contrast, color saturation.
Rear View camera not display	Camera faulty	Have a qualified installer install the camera/check for correct installation
	Camera may be blocked	Check camera for obstruction
GPS fails to locate current location	GPS antenna is not connected.	Have a qualified installer check connection
	Signal may be blocked due to tunnel, bridge, etc	Driving away from tunnel bridge etc.
Steering button malfunction /not function	Buttons are used for vehicle setting menu	Press back to exit from vehicle setting menu
	System program may be processing	Wait for a moment . Power Off then On if still not functioning

Care and Maintenance:

This multimedia navigation system utilizes highly precise and sensitive technology and should be used with care. Please follow the following suggestions to help you fulfill warranty obligations, and extend the life of the device.

- Please do not allow children to operate unit, as well as keep all parts and accessories from children.
- Keep device dry. Exposure to water, liquids, or moisture may cause damage to the vehicle or device, and may cause physical injury.
- Do not expose device and/or components to extreme heat/cold, as damage may occur and may void warranty.
- Do not attempt to open or disassemble the device. Doing so will void the warranty. If you are having issues with your device, contact authorized service centre .
- Do not use harsh chemicals, cleaning solvents, or strong detergents to clean the device.
- Do not use sharp objects to operate the LCD touch screen, as it is very easily scratched. To operate, please use the tip of your finger.



TC AUTO TOOLING SDN BHD

(A subsidiary of Tan Chong Motor Holdings Berhad)
249, Jalan Segambut, 51200 Kuala Lumpur
Email: enquiry@tcat.com.my
Tel: +603-6258-5266 Fax: +60362514014